

南安市2019-23-1地块征地勘测定界图

39638.887 2727.467 39639.547 2727.467

批次地块: 2019-23-1
 地块面积: 10.4477公顷 合156.715亩
 现状地类: 水田、水浇地、旱地、林地、其他农用地、
 建设用地、未利用地
 权属单位: 石井镇院前村

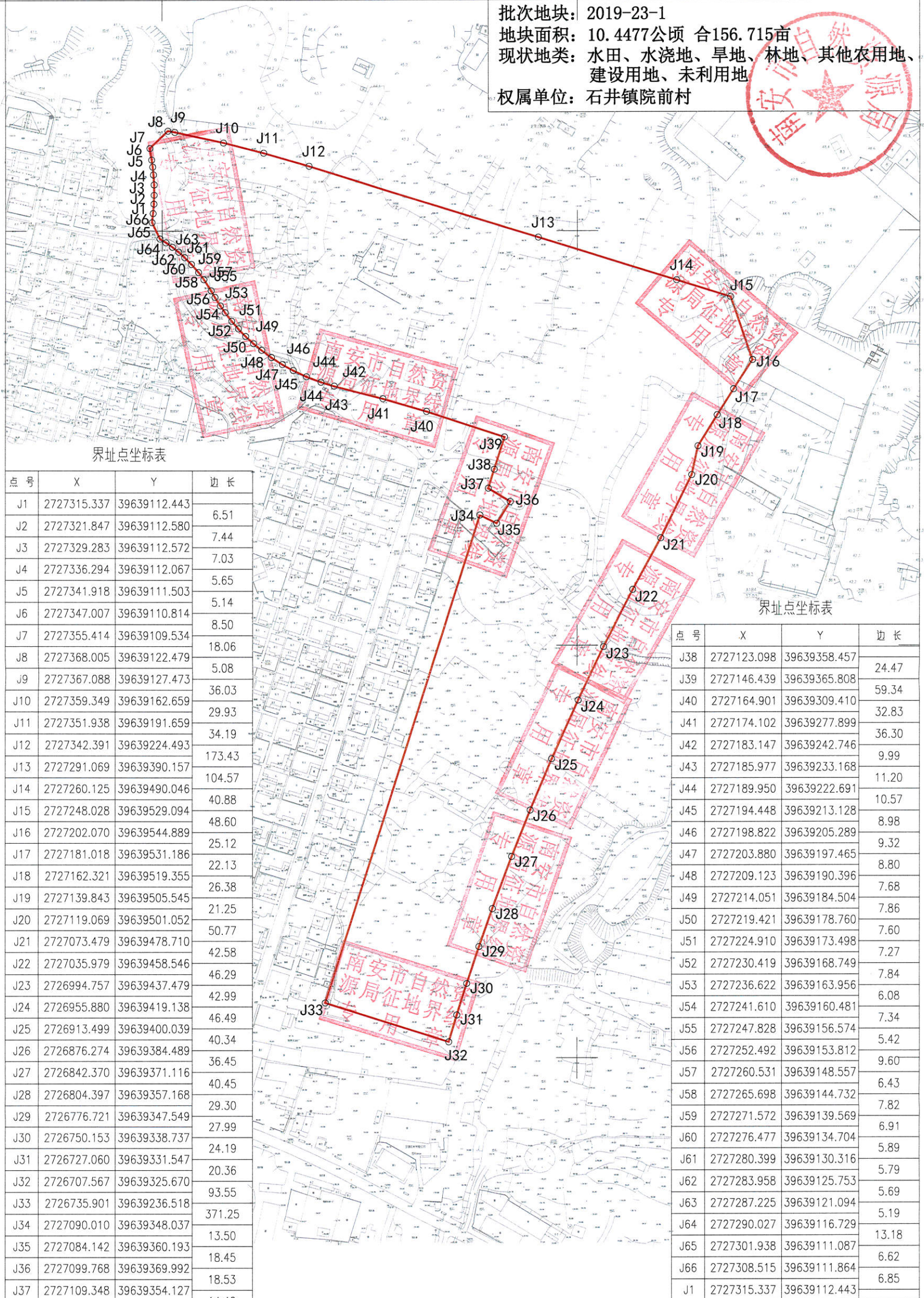

界址点坐标表

点号	X	Y	边长
J1	2727315.337	39639112.443	6.51
J2	2727321.847	39639112.580	7.44
J3	2727329.283	39639112.572	7.03
J4	2727336.294	39639112.067	5.65
J5	2727341.918	39639111.503	5.14
J6	2727347.007	39639110.814	8.50
J7	2727355.414	39639109.534	18.06
J8	2727368.005	39639122.479	5.08
J9	2727367.088	39639127.473	36.03
J10	2727359.349	39639162.659	29.93
J11	2727351.938	39639191.659	34.19
J12	2727342.391	39639224.493	173.43
J13	2727291.069	39639390.157	104.57
J14	2727260.125	39639490.046	40.88
J15	2727248.028	39639529.094	48.60
J16	2727202.070	39639544.889	25.12
J17	2727181.018	39639531.186	22.13
J18	2727162.321	39639519.355	26.38
J19	2727139.843	39639505.545	21.25
J20	2727119.069	39639501.052	50.77
J21	2727073.479	39639478.710	42.58
J22	2727035.979	39639458.546	46.29
J23	2726994.757	39639437.479	42.99
J24	2726955.880	39639419.138	46.49
J25	2726913.499	39639400.039	40.34
J26	2726876.274	39639384.489	36.45
J27	2726842.370	39639371.116	40.45
J28	2726804.397	39639357.168	29.30
J29	2726776.721	39639347.549	27.99
J30	2726750.153	39639338.737	24.19
J31	2726727.060	39639331.547	20.36
J32	2726707.567	39639325.670	93.55
J33	2726735.901	39639236.518	371.25
J34	2727090.010	39639348.037	13.50
J35	2727084.142	39639360.193	18.45
J36	2727099.768	39639369.992	18.53
J37	2727109.348	39639354.127	14.42
J38	2727123.098	39639358.457	24.47
J39	2727146.439	39639365.808	59.34
J40	2727164.901	39639309.410	32.83
J41	2727174.102	39639277.899	36.30
J42	2727183.147	39639242.746	9.99
J43	2727185.977	39639233.168	11.20
J44	2727189.950	39639222.691	10.57
J45	2727194.448	39639213.128	8.98
J46	2727198.822	39639205.289	9.32
J47	2727203.880	39639197.465	8.80
J48	2727209.123	39639190.396	7.68
J49	2727214.051	39639184.504	7.86
J50	2727219.421	39639178.760	7.60
J51	2727224.910	39639173.498	7.27
J52	2727230.419	39639168.749	7.84
J53	2727236.622	39639163.956	6.08
J54	2727241.610	39639160.481	7.34
J55	2727247.828	39639156.574	5.42
J56	2727252.492	39639153.812	9.60
J57	2727260.531	39639148.557	6.43
J58	2727265.698	39639144.732	7.82
J59	2727271.572	39639139.569	6.91
J60	2727276.477	39639134.704	5.89
J61	2727280.399	39639130.316	5.79
J62	2727283.958	39639125.753	5.69
J63	2727287.225	39639121.094	5.19
J64	2727290.027	39639116.729	13.18
J65	2727301.938	39639111.087	6.62
J66	2727308.515	39639111.864	6.85
J1	2727315.337	39639112.443	6.85

界址点坐标表

点号	X	Y	边长
J38	2727123.098	39639358.457	24.47
J39	2727146.439	39639365.808	59.34
J40	2727164.901	39639309.410	32.83
J41	2727174.102	39639277.899	36.30
J42	2727183.147	39639242.746	9.99
J43	2727185.977	39639233.168	11.20
J44	2727189.950	39639222.691	10.57
J45	2727194.448	39639213.128	8.98
J46	2727198.822	39639205.289	9.32
J47	2727203.880	39639197.465	8.80
J48	2727209.123	39639190.396	7.68
J49	2727214.051	39639184.504	7.86
J50	2727219.421	39639178.760	7.60
J51	2727224.910	39639173.498	7.27
J52	2727230.419	39639168.749	7.84
J53	2727236.622	39639163.956	6.08
J54	2727241.610	39639160.481	7.34
J55	2727247.828	39639156.574	5.42
J56	2727252.492	39639153.812	9.60
J57	2727260.531	39639148.557	6.43
J58	2727265.698	39639144.732	7.82
J59	2727271.572	39639139.569	6.91
J60	2727276.477	39639134.704	5.89
J61	2727280.399	39639130.316	5.79
J62	2727283.958	39639125.753	5.69
J63	2727287.225	39639121.094	5.19
J64	2727290.027	39639116.729	13.18
J65	2727301.938	39639111.087	6.62
J66	2727308.515	39639111.864	6.85
J1	2727315.337	39639112.443	6.85

S=104477平方米 合156.715亩

2726.507 39638.887 39639.547 2726.507

泉州诚信测绘咨询有限公司

2019年12月数字化制图。
 2000国家大地坐标系，中央子午线117度。
 1985国家高程基准，等高距为1米。
 2007年版图式。

1:3000

泉州诚信测绘咨询有限公司
 测绘资质: **丙级**
 证书编号: 丙测资字3523039
 发证机关: 福建省测绘局

测量员: 姜志坚
 绘图员: 姜志坚
 检查员: 张维博