

南安市2019-24-4地块征地勘测测定界图

39643.197 39643.437
2780.191 2780.191

批次地块：2019-24-4
 地块面积：0.7001公顷 合10.501亩
 现状地类：园地、其他农用地、建设用地、未利用地
 权属单位：梅山镇林坂村

界址点坐标表

点号	X	Y	边长
J1	2780099.277	39643392.895	
J2	2780089.706	39643386.969	11.26
J3	2780073.817	39643374.276	20.34
J4	2780045.941	39643363.885	29.75
J5	2779994.764	39643361.951	51.21
J6	2779993.623	39643363.623	2.02
J7	2779990.866	39643366.430	3.93
J8	2779988.859	39643368.014	2.56
J9	2779956.095	39643382.659	35.89
J10	2779960.607	39643396.429	14.49
J11	2779968.983	39643415.299	20.64
J12	2779970.448	39643415.208	1.47
J13	2779971.921	39643415.638	1.53
J14	2779973.983	39643416.650	2.30
J15	2779975.427	39643418.056	2.02
J16	2779976.722	39643420.425	2.70
J17	2779977.135	39643422.366	1.98
J18	2779977.048	39643423.825	1.46
J19	2779976.606	39643424.789	1.06
J20	2779975.837	39643426.004	1.44
J21	2779974.942	39643427.237	1.52
J22	2779975.690	39643428.624	1.58
J23	2779975.595	39643429.104	0.49
J24	2779991.099	39643433.330	16.07
J25	2779993.358	39643433.961	2.35
J26	2780007.058	39643435.012	13.74
J27	2780017.672	39643436.009	10.66
J28	2780027.789	39643437.108	10.18
J29	2780040.021	39643438.632	12.33
J30	2780042.446	39643432.947	6.18
J31	2780044.694	39643425.479	7.80
J32	2780046.808	39643419.846	6.02
J33	2780050.814	39643419.736	4.01
J34	2780053.888	39643414.340	6.21
J35	2780055.332	39643414.583	1.46
J36	2780057.865	39643405.282	9.64
J37	2780061.335	39643400.289	6.08
J38	2780064.349	39643398.754	3.38
J39	2780067.346	39643396.879	3.54
J40	2780070.659	39643399.587	4.28
J41	2780070.833	39643399.238	0.39
J42	2780087.319	39643410.540	19.99
J43	2780094.785	39643400.453	12.55
J1	2780099.277	39643392.895	8.79

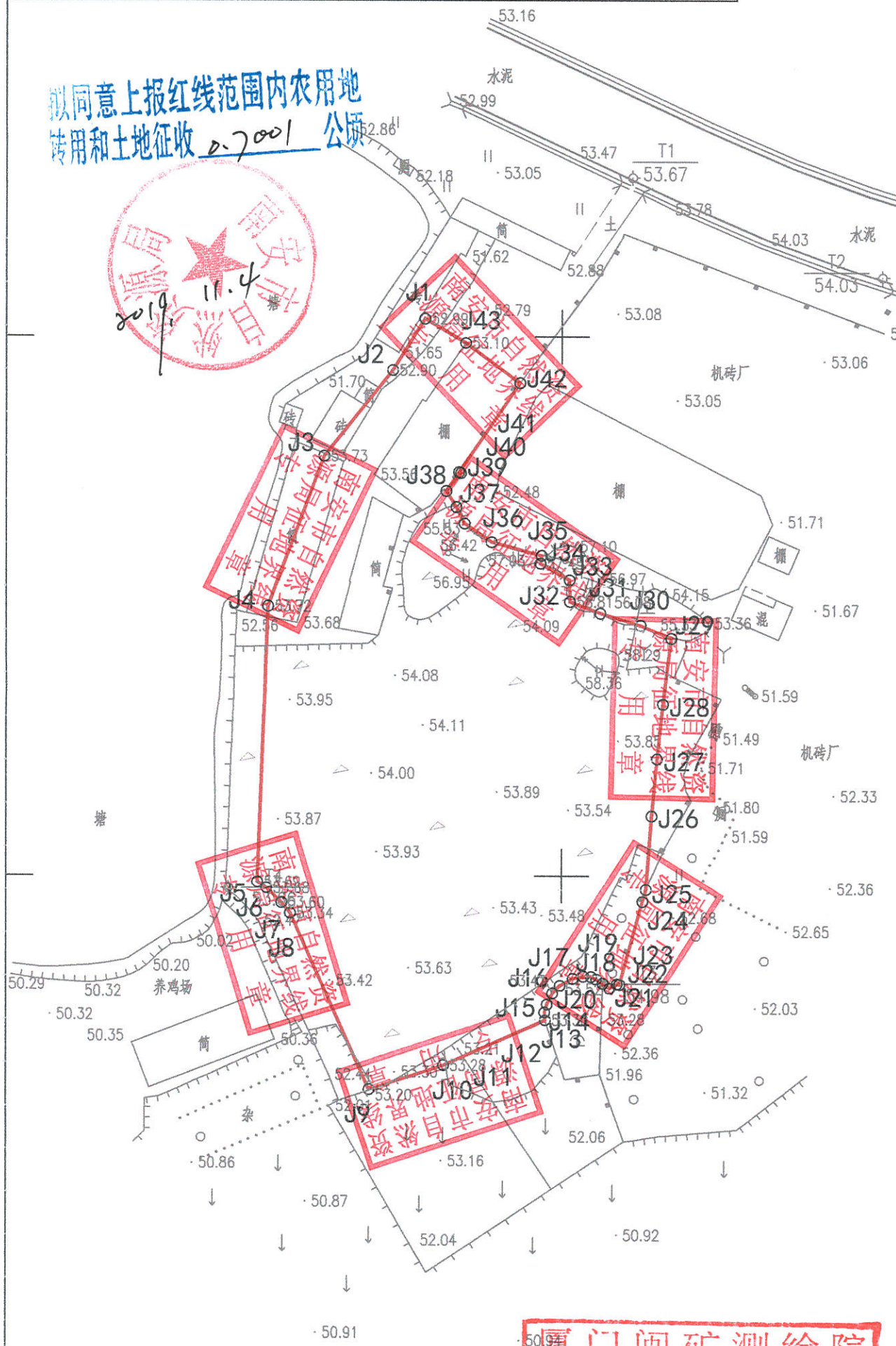

厦门闽矿测绘院
 测绘资质：甲级(2)
 证书编号：甲测资字3500148
 发证机关：国家测绘地理信息局

S=7001平方米 合10.501亩

2779.891 2779.891

39643.197 39643.437

2019年10月数字化制图。
 2000国家大地坐标系：中央子午线117度。
 1985国家高程基准，等高距为1米。
 2007年版图式。

1:1000

测量员：傅新荣
 绘图员：李益红
 检查员：詹钟瑜

厦门闽矿测绘院