

南安市2019-9-1地块征地勘测界定界图

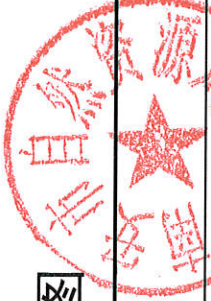

39638.205
2727.745
39639.085
2727.745

拟同意上报红线范围内农用地
转用和土地征收 0.7173 公顷

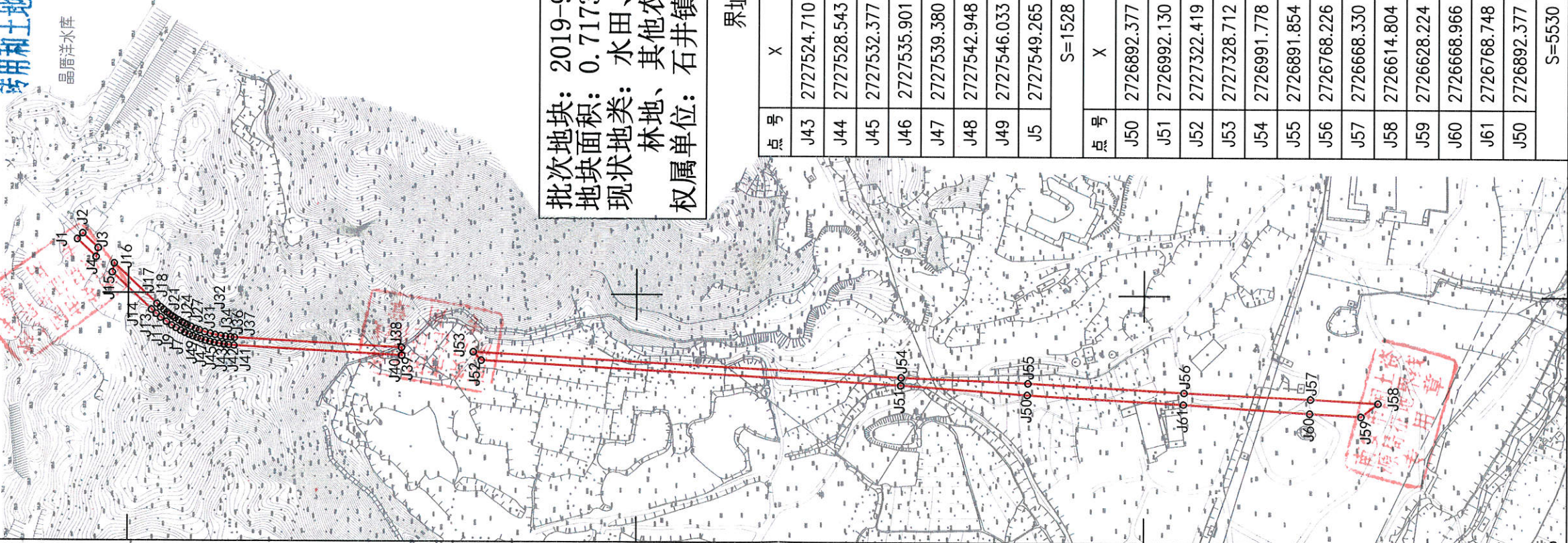

界址点坐标表

点号	X	Y	边长
J1	2727640.399	39638442.020	6.20
J2	2727636.141	39638446.526	16.75
J3	2727623.965	39638435.021	7.21
J4	2727625.554	39638427.992	20.43
J1	2727640.399	39638442.020	

S=115 平方米 合0.173亩

点号	X	Y	边长
J5	2727549.265	39638365.914	3.11
J6	2727552.140	39638367.110	3.81
J7	2727555.608	39638368.691	3.52
J8	2727558.757	39638370.265	4.25
J9	2727562.480	39638372.304	4.01
J10	2727565.915	39638374.368	5.14
J11	2727570.201	39638377.210	5.58
J12	2727574.685	39638380.531	4.67
J13	2727578.277	39638383.514	4.87
J14	2727581.914	39638386.755	42.61
J15	2727612.881	39638416.017	7.21
J16	2727611.293	39638423.046	46.28
J17	2727577.655	39638391.261	3.80
J18	2727574.841	39638388.704	3.25
J19	2727572.361	39638386.611	3.33
J20	2727569.741	39638384.547	2.50
J21	2727567.729	39638383.058	2.81
J22	2727565.423	39638381.448	2.42
J23	2727563.405	39638380.118	3.43
J24	2727560.489	39638378.321	3.19
J25	2727557.719	39638376.741	1.91
J26	2727556.040	39638375.840	2.30
J27	2727553.985	39638374.796	3.52
J28	2727550.799	39638373.295	3.89
J29	2727547.218	39638371.773	3.12
J30	2727544.308	39638370.658	4.65
J31	2727539.904	39638369.170	4.48
J32	2727535.596	39638367.938	3.90
J33	2727531.806	39638367.029	4.63
J34	2727527.261	39638366.148	3.70
J35	2727523.603	39638365.601	3.99
J36	2727519.638	39638365.168	3.04
J37	2727516.609	39638364.948	131.79
J38	2727385.031	39638357.464	6.16
J39	2727384.912	39638351.300	0.07
J40	2727384.964	39638351.250	132.21
J41	2727516.961	39638358.758	4.33
J42	2727521.277	39638359.095	3.46
J43	2727524.710	39638359.493	

批次地块：2019-9-1
地块面积：0.7173公顷 合10.76亩
现状地类：水田、旱地、园地、
林地、其他农用地、建设用地
权属单位：石井镇院前村

界址点坐标表

点号	X	Y	边长
J43	2727524.710	39638359.493	3.88
J44	2727528.543	39638360.077	3.90
J45	2727532.377	39638360.810	3.62
J46	2727535.901	39638361.618	3.60
J47	2727539.380	39638362.545	3.73
J48	2727542.948	39638363.633	3.26
J49	2727546.033	39638364.688	3.46
J5	2727549.265	39638365.914	

S=1528 平方米 合2.292亩

点号	X	Y	边长
J50	2726892.377	39638321.727	100.01
J51	2726892.130	39638328.904	330.82
J52	2727322.419	39638347.692	9.10
J53	2727328.712	39638354.260	337.48
J54	2726991.778	39638335.094	100.01
J55	2726891.854	39638330.912	123.83
J56	2726768.226	39638323.880	100.01
J57	2726668.330	39638319.199	53.61
J58	2726614.804	39638316.154	17.01
J59	2726628.224	39638305.700	40.81
J60	2726668.966	39638308.017	100.01
J61	2726768.748	39638314.695	123.83
J50	2726892.377	39638321.727	

S=5530 平方米 合8.295亩

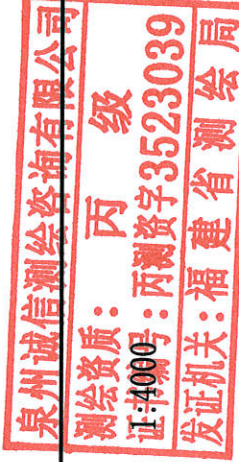

39638.205
2726.465

39639.085
2726.465

2019年1月数字化制图。
2000国家大地坐标系：中央子午线117度。
1985国家高程基准，等高距为1米。
2007年版图式。

测量员：姜志坚
绘图员：姜志坚
检查员：康昌文